

**SPORT**  
PRACTICAL EVERYDAY STROLLER



## SPORT

---

### PLEASANT DRIVING THANKS TO SWIVELLING FRONT WHEELS

The Sport stroller is very easy to push. The front wheels are swiveling and lockable handling corners and uneven terrain with ease.

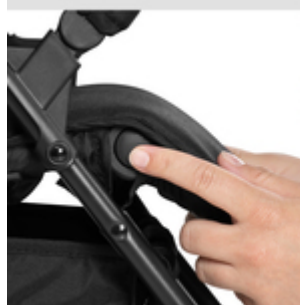
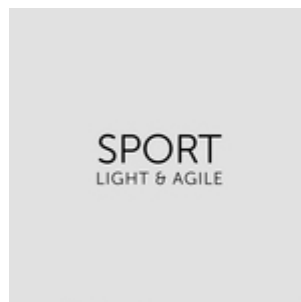

### *little one's* WELL-BEING



### COMFORTABLE THANKS TO ADJUSTABLE SEAT

Both the backrest and footrest can be adjusted in a comfy position for when your little one wants to rest. In addition, the canopy protects your child against sun, rain and wind.

### EASY AND COMPACT FOLDING FOR TRANSPORT

The Sport stroller folds away very easily. The compact size fits almost any car boot, making it the perfect travel companion.



## SPORT

---

### BABY THINGS RIGHT AT HAND IN THE LARGE BASKET

The large basket beneath the seat offers much space for your baby's equipment, toys or even your purchases.



SPORT  
PRACTICAL EVERYDAY STROLLER



Product Images

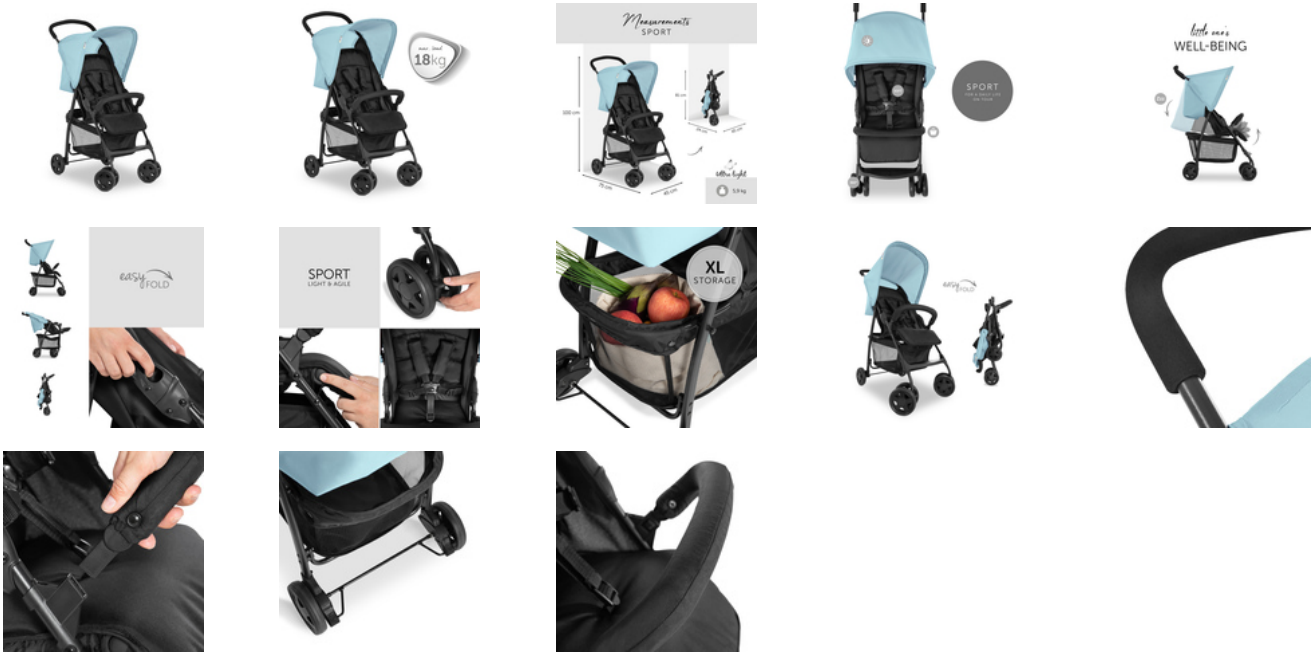

## **Everyday stroller**

### **Light, compact and manoeuvrable**

On the bus or off to the park? With swivelling and lockable front wheels, the Sport stroller is easy to use anywhere.

Going somewhere in a hurry? Or leaving on holiday with a lot of luggage? The stroller folds up in a jiffy and is so compact, it hardly takes up any space – perfect for travelling or to leave with the grandparents as a spare.

### **Comfortable and safe**

Whether sitting or resting, your child will be comfortable in the Sport stroller with its easily adjustable backrest and footrest. The canopy protects them from wind and weather while you both enjoy the views. A 5-point harness ensures that they cannot climb or fall out and the brake means the stroller is always secure – even in a moving bus.

### **Ample storage space in the XL basket**

Toys, nappy bag, food: even quick outings have baggage. And for shopping, everything you need fits into the XL basket under the seat.

## **Shipping**

- Stroller

**Product net weight** 5,90 kg 13.01 lb / US

### Dimensions

**Folded** 31.9 x 17.7 x 9.4 in

**Built up** 29.5 x 17.7 x 39.4 in

**Lying area** 28.3 x 12.2 in

**Dimensions backrest** 17.3 x 11.4 in

**Dimensions seat area** 7.9 x 12.6 in

**Shopping basket** Yes

**Detachable front bar** Yes

**Suspension** Yes

**Brake type** Combined brake system

**Max. load** 40 lbs (33 lbs kids + 7 lbs basket)

**Legrest adjustment** 4 x

**Harness** 5-Point harness

**Age information** 0 - 36 months

### Wheels

**Swivelling and lockable front wheel(s)** Yes

**Diameter front/back wheel** 5.31/5.31 in

**Detachable wheels** Front and back wheel

**Wheel type** Plastic wheel

### Backrest

**Backrest adjustment** continuously /100 - 152 °

**One-handed backrest inclination** Yes

### Handle

**Handle height** 39.76 in